

4S SMART
SOLUTIONS FOR
SPINNING
SUCCESS



LMW PACE is the latest offering from the house of LMW aimed at bringing the customer, our most valued stakeholder even closer to our business. Winning is not just about supplying products and services as you, the customer wants, but going beyond the obvious and catering to your stated and unstated needs. This is possible only when LMW works closely together with you, our customers.

PACE stands for **Professional Aftermarket Care for Excellence**. This is an endeavour to deliver excellence that helps you win. There are many aspects to delivering excellence. At LMW, we believe in creating excellence through 3 pathways, which are

- Providing timely support on Parts and Components that ensure you never lose out on productivity or quality
- State of the art commissioning and technical solutions that ensure your installation, commissioning and machine running experiences are always at the pinnacle of satisfaction
- Life Cycle Services that ensure your overall ownership experience is world class.

PACE is our commitment to delivering excellence through every touch point and is a manifestation of our commitment to your success.



COMPONENTS AND PARTS

LMW is one of the very few spinning machinery manufacturers who offer the entire range of spinning solutions from Blow room to Winding. With an extended sales and service network across the globe backed by state-of-the-art infrastructure, LMW has established itself as a trusted partner in the global textile market.

LMW, the totally integrated spinning system supplier with over 50 million spindles in operation across the globe, is dedicated to 'Innovation and Value Creation' for the customer in every product and service. LMW Components and Parts are engineered with cutting-edge manufacturing technologies which deliver the best value for the customers.

To facilitate easy spare parts management of a spinning mill, LMW has set up a customer portal which facilitates quote creation and order placement. Portal ensures round the clock service on complete tracking of orders from booking to execution.

LMW Components and Parts are of the same specification and quality standards as that used in machines thereby ensuring continued performance of machines at par with OEM standards.

LMW as an active business partner and trusted source for quality spare parts help you spin quality yarn.

TECHNOLOGICAL COMPONENTS

Inclined Profile Ring:

On continuous product improvement aiming for higher speed, production and service life especially in man-made fibre processing, LMW introduces another Ring profile variant called Inclined Profile Ring. This Ring differs from conventional Ring profile such that the geometry is altered to maximize Traveller contact area, reducing load per unit area and dissipating heat more efficiently at higher spindles speed.

INCLINED PROFILE RING

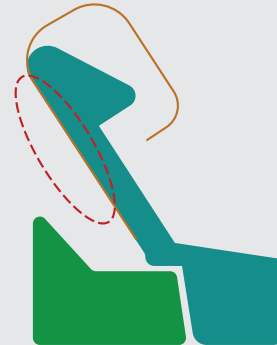

Salient Features :

- Higher Traveller speed
- Higher Traveller contact area
- Reduced load per unit area
- Efficient heat dissipation
- Reduction in thermal load between Ring & Traveller
- Avoid thermal damages in Lycra and Polyester materials.
- Higher yarn clearance

Benefits :

- Increased production up to 10% (Subject to process parameters & technological requirements)
- Higher Ring life
- Shorter running - in

Technical Data:

Material Application: Synthetic, Core Yarn & Blends

Ring Dia: 36 / 38 / 40 / 42 mm

Count: 16s to 60s Ne

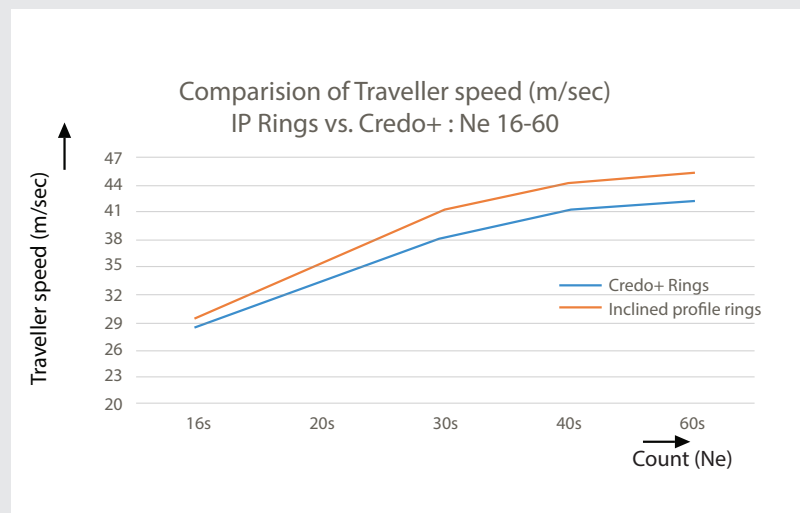

CREDO+ RING

Credo+ Ring has been developed by optimizing the key profile dimensions - Flange width, height & web thickness to achieve best spinning performance at higher spindle speed with short running-in.



Salient Features :

- Optimum yarn clearance
- High Traveller stability
- Shorter running-in period
- Higher wear resistance
- Reduced Co-efficient of friction
- Improved corrosion resistance

Benefits :

- Higher productivity
- Improved quality - Hairiness CV
- Better Traveller stability
- Lesser running-in of the Traveller
- Lesser end breakages
- Consistent performance

ENERGY EFFICIENT SILENT SPINDLE (HLED)

LMW launches new Spindles HLLD and HLED in the market which are world class innovations. Energy efficient, silent, high-performance Doffer and Non-Doffer Spindles from LMW are manufactured in the state-of-the-art facilities. Every care is taken to meet high quality and precise standards.

Spindle is designed with a double elastic viscous damping construction which can handle higher radial loads and allow smoother running performance at higher speeds.



HLED SPINDLE

- Reduced wharve dia 17.5mm results in power savings upto 10% (40s and finer count - Cotton material)
- Reduction in noise level upto 5 dBA
- Reduction in Spindle bolster vibration level by 50%
- Spindle oil consumption reduced upto 25% per Spindle
- Can run upto 30,000 rpm mechanically

HLLD SPINDLE

- Vibration is reduced by 50% when compared to conventional (single elastic) Spindles
- Noise reduction upto 5 dBA
- Increased Spindle life
- Can run upto 30,000 rpm mechanically

LMW Spindle Bolster Construction :

LMW Spindle Bolster Construction:

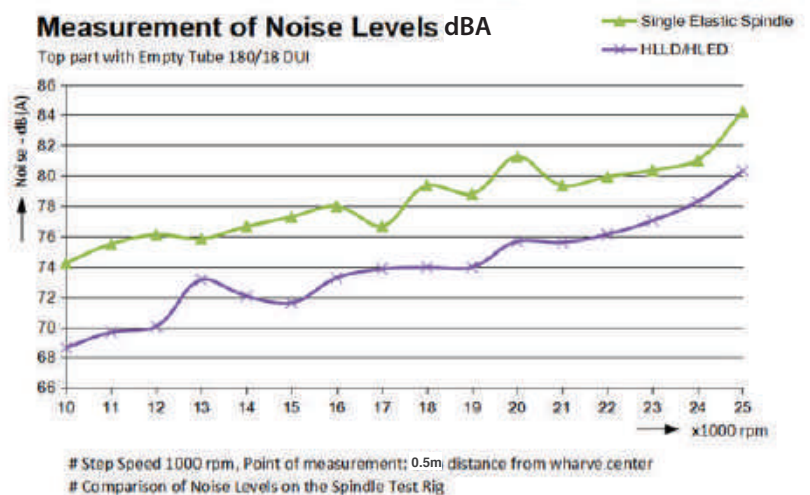
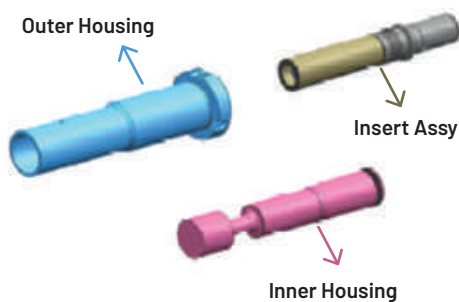

FORMULA SERIES COTS AND APRONS



LMW's success in Cots is due to the consistency in maintaining the surface characteristics like structure, finish and the ability to maintain the desired surface roughness value (Ra). Besides the above characteristics, LMW Cots provide good resistance to abrasion, heat, pressure and fibre lapping.

Salient Features :

- High quality synthetic rubber with state-of-the-art manufacturing technology ensures longer buffering schedule.
- Maintains optimum Ra value throughout the buffering cycle and life of Cots.
- Good Anti-static property and enhanced surface resistivity
- Reduction in lapping resulting minimal end breakage rate
- Alucore Cots maintain good parallality with required shore hardness throughout its life.

PARTS

- As a world-class machinery manufacturer, we supply a wide range of parts to enhance machine performance with OEM standards.

TOP ROLLERS (DRAW FRAME)

Top Rollers are manufactured in-house with exclusive facility backed by stringent quality control process. Replacement of Top roller every 1-2 years helps to,

- Reduce end breaks
- Reduce IPI levels
- Reduce objectionable faults - Short & Long thick , Short & Long thin
- Avoid undrafting / lapping



NIPPER

Timely replacement of Nipper enables to

- Achieve higher Nep Removal Efficiency (NRE%).
- Reduce Head to Head variation in Noil extraction.
- Reduce good fiber loss

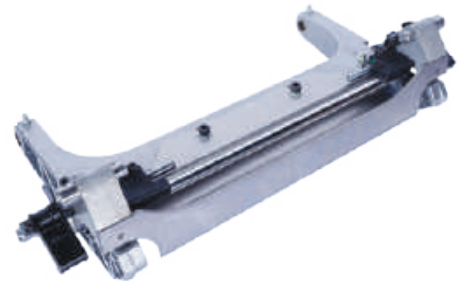

FLYERS

Replacement of Flyers every 6 to 8 Years ensures

- Reduction in U%,
- Avoid choking tendency due to interior surface deterioration.
- Achieve better bobbin CV%.
- Eliminate frequent roving breaks



TOP ARM

Replacing Top arm every 8 to 10 Years helps

- Eliminate undrafting
- Reduce high end breaks
- Reduce idle Spindles due to defective Top arm
- Avoid uneven performance resulting in poor quality
- Reduce classimat faults



TOP ROLLERS (RING FRAME)

Timely replacement facilitates

- Perfect fitment of Cots for better and consistent quality of yarn
- Less chance of peaks in the delivered yarn
- Delivering superior yarn quality
- Yarn quality improvement in terms of IPI & U%
- Ease of handling with precise fit on the Top arm



AUTO-DOFFER PARTS:

Timely replacement helps to

- Minimize manual intervention during doffing
- Avoid cops top damage
- Reduce air consumption.



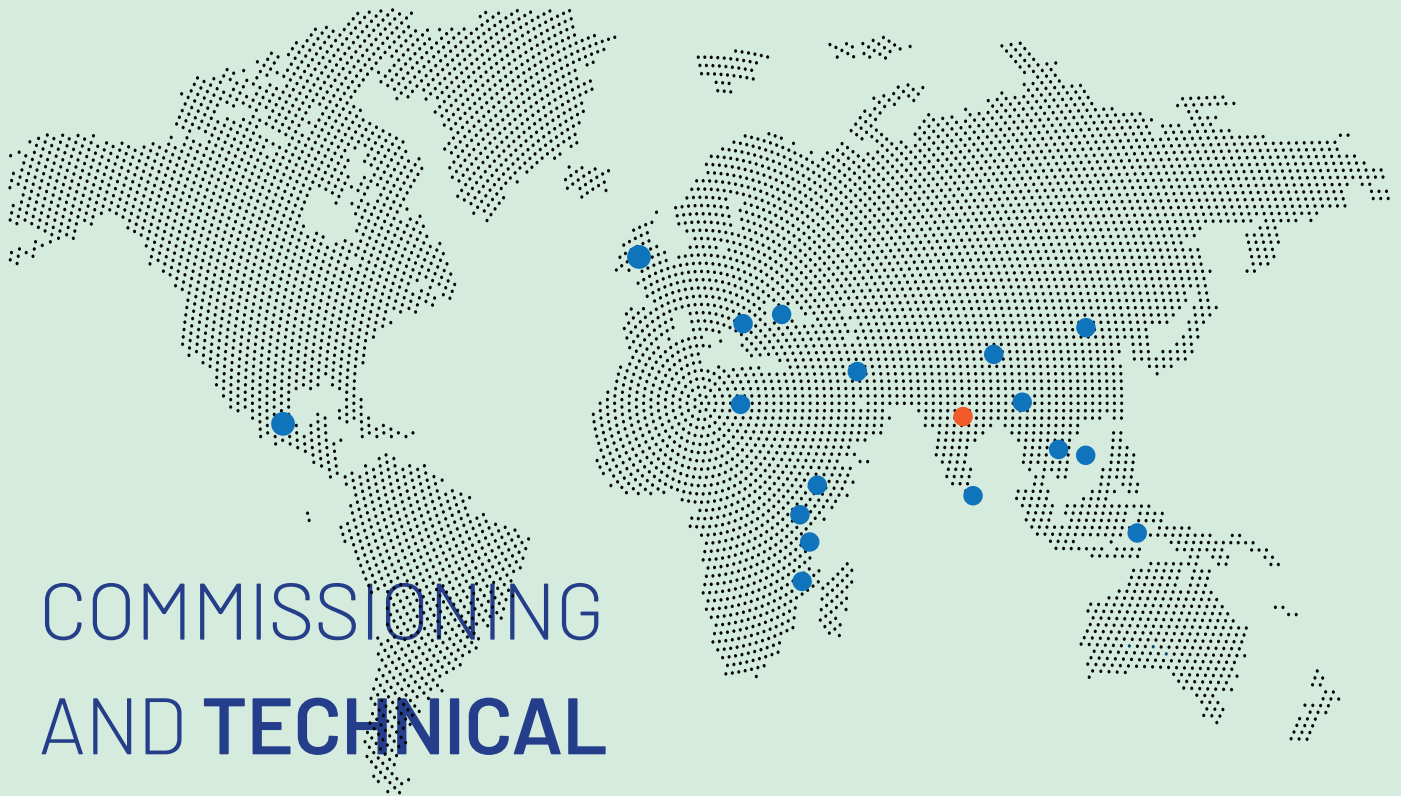

COMMISSIONING AND **TECHNICAL** SOLUTIONS

Successful delivery of value is built not just on a well-designed and manufactured machine, but also on the efficient installation and commissioning of the machines as well. It does not end there... machines have thousands of moving components and operate under diverse conditions making timely repairs a critical cog in the whole ecosystem. With expertise gained over 6 decades of catering to every need of the spinning sector, nobody understands this better than LMW.

With the advantage of synchronized service, starting from installation management to a complete after sales service, we provide unsurpassed support.

WE OFFER:

Unitary Machine Installation and Project Installation which includes:

- Project management at every stage
- Erection and commissioning as per procedure
- Fine tuning and achieving productivity and quality

Our after sales partnering includes Technical Service Modules such as:

- Maintenance Audits
- Quality of end product
- Energy Audits
- Customer Training on site

We have a widespread network of product experts and trained local engineers at all major cities such as Ahmedabad, Bangalore, Bhilwara, Chandigarh, Coimbatore, Guntur, Hyderabad, Indore, Kohlapur, Madurai, Mumbai, Nagpur, and New Delhi who carry out periodic visits with a strong technical team.

Components and spares are readily available with a steady stock of recommended spares, electrical components and critical items.

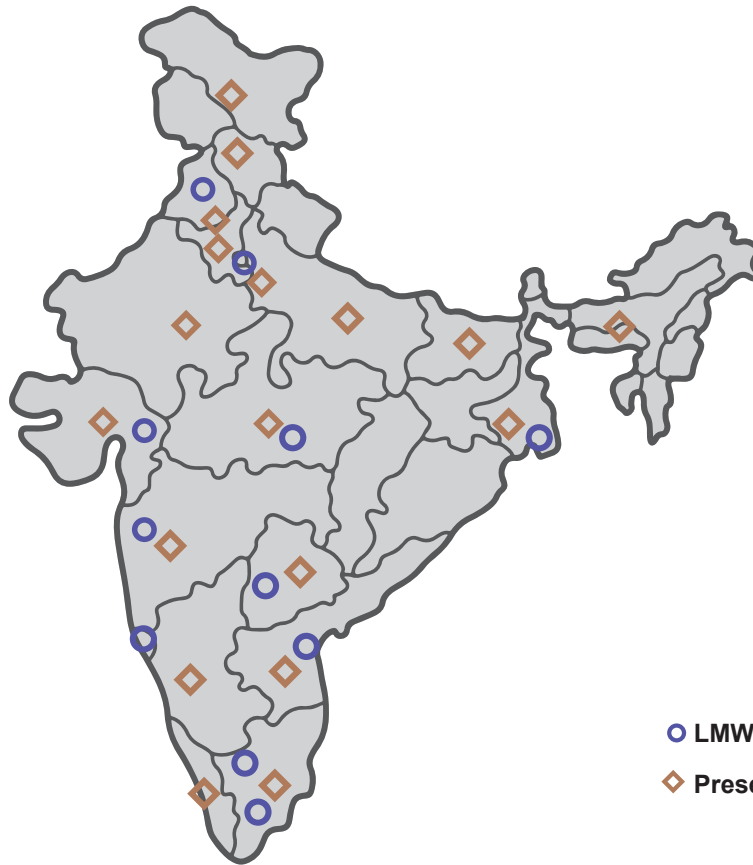

Scope of Activities

Installation Management

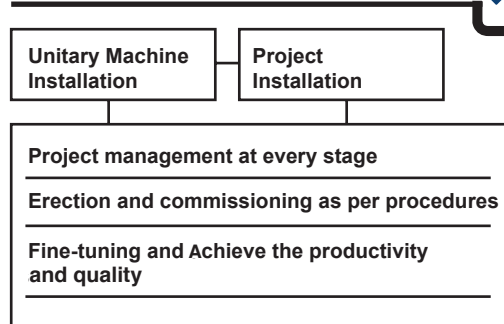

After Sales Services - Service partnering

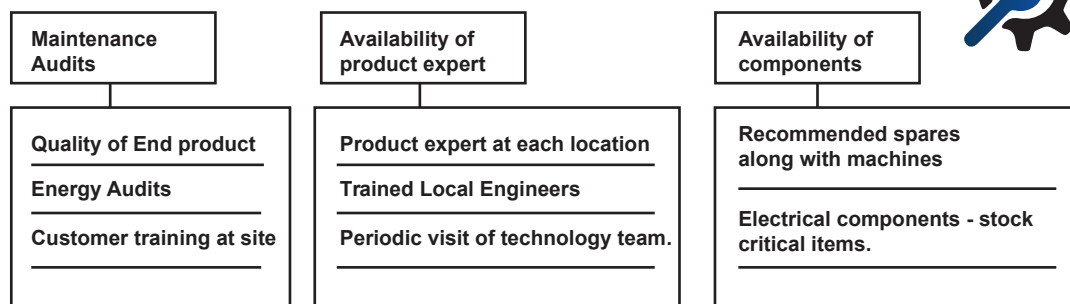

LIFE CYCLE SERVICES

Our machines last for a lifetime and so does our relationship with you, our beloved customers. We consider it our duty to ensure that as technology evolves in leaps and bounds you are not left behind.

Our Life Cycle Services offering is our commitment towards your continued success. Be it the Performance Enhancement Kits that upgrade earlier model machines, or the AMCs that ensure zero downtime under diverse

working conditions, we are committed to supporting your journey of progress and success.

We have endeavoured at every step to come closer to you, our customers and our cutting edge cloud based online services for spares booking, service requests and feedback are crafted to ensure your voice is heard and becomes part of our decision making process.

Maximise machine up-time & Maintenance Audits



- Machinery Health Assessment
- AMC
- Suggests PEK / Spares / Updation

Quality of End product

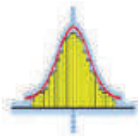

- Technological Partnership with customer - Optimization of Process.
- Quality - Customer's Customer expectation

Energy Audits



- Energy Audits & Power study
- Electrical critical Spares maintaining

Training - Customer On-site



- Training to Customers - On-site
- Troubleshooting guidelines

PERFORMANCE ENHANCEMENT KIT:

Performance Enhancement Kit (PEK) are manufactured with advanced technology to provide customers with consistent performance to enhance the quality of the product and also to increase the health and longevity of the machines.

PEK TO EXCEL

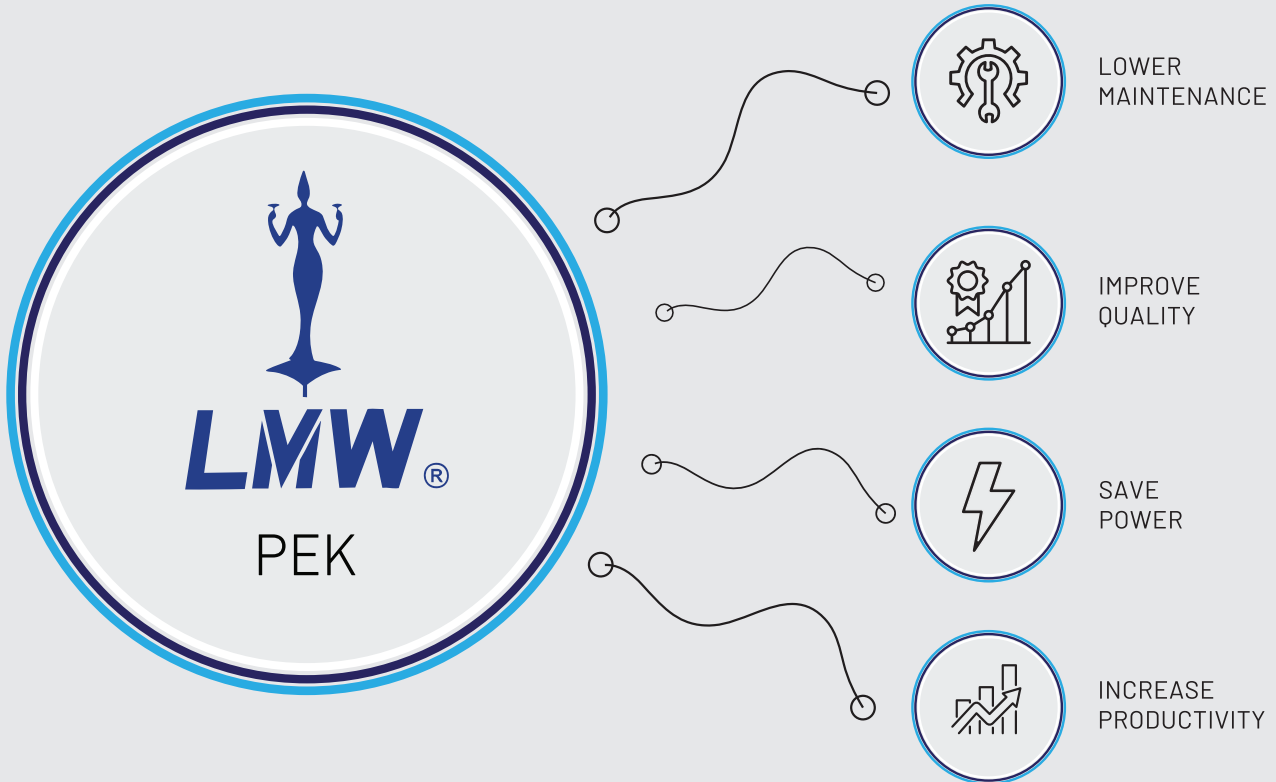

REPAIR SERVICES

ELECTRICAL / MECHANICAL REPAIR SERVICE @ LMW

LMW has a dedicated team of people and state-of-the-art infrastructure for servicing the mechanical & electrical parts covering entire range of products. Customers can avail our repair service for all machine parts of their ring spinning line. Key mechanical parts that are serviced include Gear box / Beaters / Lattice / Nippers. Key electrical items that are serviced include Inverters, Displays, Servo drives and Motors.

OEM servicing of parts will help in better enhancement of the life and performance of the machines & processes. The servicing is handled by experts ensuring the reliability and consistent quality.

Replace with OEM Parts

Quality Service

Genuine & Quick Service

- + Stand-by support for key electrical parts
- + AGP (Alternate Good Piece) for electrical items
- + On-site repair service

1 Year Warranty on Repair Service Components



ONLINE RELATIONSHIP MANAGEMENT

LMW Customer Portal



To facilitate easy spare part management of a spinning mill, LMW Customer Portal with innovative features offers more benefits to customers. Customers can log-in round-the-clock in the portal, ensuring immediate booking and quicker despatch. LMW Customer Portal includes the following deliverables.

- Visual catalogue available for parts ordering
- Ordering dynamic data indicating all updates on drawing numbers
- Responsive website
- Fast track ordering - Payment and order integration for immediate order booking
- Order tracking from quote to physical delivery @customer end
- Transaction details - Invoice , payment & pending order
- Recommended stores portfolio - Quick ordering
- 24 X 7 online ordering facilities
- Upload facilities through excel for proforma generation
- Order booking & dispatch - Alert message through email
- Product news flashes - Recently launched upgrades & kit
- E-Bulletin with performance data e-catalogue of parts to reduce operating cost



LMW LIMITED

(formerly Lakshmi Machine Works Limited)
Perianaickenpalayam, Coimbatore - 641 020, India.
Phone : +91 422 719 2255 E-Mail : info@lmwtd.com
www.lmwtd.com

